

A φ X3
B φ X7
C φ X3

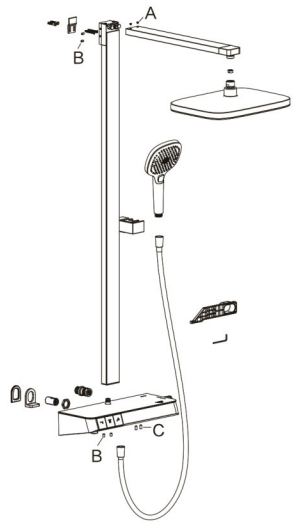

CH 安装完成后，本说明书务必交由客户保存。

EN After installation, make sure this instruction is handed to and kept by the customer.

使用条件

- 适用水流压力：0.1MPa~0.5MPa，超过0.5MPa需加装减压阀。推荐水流压力：0.2MPa~0.5MPa。
- 供热水请勿使用蒸汽，适用水温：冷水4℃~29℃,热水55℃~85℃。燃气热水器推荐设定温度：夏季：55℃~60℃ 其他季节：60℃~65℃。
- 连接进水管道螺纹G1/2中心距150±10mm，必须保证左热右冷。
- 冷热水管道的压力差不允许超过50%，否则必须在高压水端增加水流限制器。
- 适用热水供水源：适用于承压储水式热水器，适用于热功率12L及以上燃气热水器且需调试配套使用，详见下文《校准说明》。
- 使用环境温度4℃以上，如果低于4℃，产品可能会出现变形、冻裂等现象。

安装方法

- 安装之前，务必清理管中杂物、砂粒等异物，避免造成堵塞，如图1。
- 图1~2为管道安装注意事项和S接头、墙座安装步骤。
- 安装和连接步骤参见图3~6，因产品功能配置不同，图示带△配件仅限于安装指引，请以实物为准。

安装结果检查

- 检查并确保所有的衔接处都已拧紧，手柄处于关闭位置（此为出厂状态），如图7。
- 打开冷热水供水管，检查各衔接处是否有渗漏！检查产品的安装是否正确，如图6。（因产品功能配置不同，请以实物为准）
- 将起泡器、太阳花洒、手握花洒拆下，开启把手，切换冷热水及各档位，让水从各出水口流出以清除杂物。再关闭把手重新装回起泡器、太阳花洒、手握花洒。

九牧产品的清洁建议

- 为了避免产品损伤和由此带来的投诉及争议，必须在使用和清洁产品时遵循本规程。
- 只能使用有明确注明是适用于本产品的清洁剂，含磷酸的清洁剂必须在特定条件下使用。
- 不允许使用含有盐酸、蚁酸、醋酸和含氧的碱性漂白剂，这会和产品表面造成严重损伤。
- 不允许使用具有研磨作用的清洁工具和其他设备，如蒸汽清洗机，高温会损害产品。
- 必须严格遵守清洁剂生产厂商的使用说明。
- 定期的清洁以防防水垢，清洁时，严格遵守清洁剂的用量和作用时间，绝不允许清洁剂的作用时间长于规定值。
- 不允许将清洁剂直接喷射到产品表面，因为清洁剂会进入产品部件缝隙中而造成损害。首先将清洁剂喷在软布上，再用软布擦拭产品表面。
- 清洁之后必须用足够的水冲洗产品表面，以去除残留在产品表面的清洁剂。
- 使用时如果发现起泡器堵塞或者有水流量变小的情况，需拆下起泡器清理杂物，清理完后需将起泡器装回产品相应位置。
- 使用时如果发现花洒洒水无规律断断续续流出时，则是有杂物堵住出水口，这时只需轻轻拨动花洒出水口的软胶，细小杂物则会自动被水冲出。

重要说明

- ⊗ 肥皂、洗发水、沐浴液的残留也会损伤龙头表面因此在沐浴后要把龙头表面用清水冲洗干净。
- 注意：在已经损伤的表面继续使用清洁剂会给表面造成更大的损伤。
- ⊗ 表面损坏的部件必须更换，否则会有受伤的危险。不按规定进行清洁而造成的任何损坏不在本公司产品保修范围之内。
- ⊗ 我公司一贯奉行不断提高和改善产品设计与性能的政策，并保留对产品规格的更改权利，届时恕不另行通知,图示仅限于安装指引，请以实物为准。

△ 校准说明

- 安装前需向顾客了解热水器日常使用情况，确认热水器出水温度稳定性，无异常后进行安装。
- 所有产品安装完成后，必须检查产品的出水温度，如产品出水端测量所得的温度与产品上设定的温度有偏差，那么必须进行调节。
- 搭载燃气热水器安装完成后，分别设定热水器温度55℃、60℃、65℃测试出水效果，如产品出水异常需进行调试最佳状态并指导顾客使用。

问题	原因	补救
安装后产品不出水，出水量小	- 冷热水接反 - 一端管路不进水 - 水压不在适用范围内	- 检测冷热进水端是否左热右冷 - 检查管路进水情况 - 测试冷热进水端水压值
正常使用一段时间后不出水、出水量小	- 恒温阀芯、单向阀堵塞	- 清洗恒温阀芯、单向阀，如有必要则更换新的
水温无法调节	- 恒温阀芯内部结垢 - 恒温阀芯杂质堵塞	- 清洗恒温阀芯，如有必要则更换新的
出水温度和预先设定的不符	- 恒温阀芯未调节 - 热水进水温度过低	- 调节恒温阀芯 - 将热水温度升高到55℃-65℃
串水、在产品关闭的状态下，冷水强迫流入热水端、或者相反	- 单向阀堵塞或漏水	- 清洗单向阀，如有必要则更换新的
搭载燃气热水器使用时，出水温度无法升高	- 水压偏高，出水流量偏大，热水器功率不足	- 增加花洒出水限流器 - 调低热水器设定温度
搭载燃气热水器使用时，不点火或水温不稳	- 水压偏低，出水流量偏小，热水器高温熄火	- 拆除花洒出水限流器 - 调高热水器设定温度



九牧厨卫股份有限公司

邮箱: jomoo@jomoogroup.com

网址: www.jomoogroup.com

Application conditions

- The applicable water pressure: 0.1MPa ~ 0.5MPa. It requires installation of the decompression valve when above 0.5MPa. Recommended water pressure: 0.2MPa ~ 0.5MPa.
- Do not use steam for supplying hot water. The applicable water temperature: cold water 4℃ ~ 29℃, hot water: 55℃ ~ 85℃. Recommended setting temperature of gas water heater: summer: 55℃ ~ 60℃ other seasons: 60℃ ~ 65℃.
- The central distance between inlet pipe screw thread G1/2 should be around 150±10mm. You must ensure that the left is hot while the right is cold.
- The pressure difference between hot and cold water pipes is not allowed to exceed 50%, otherwise the water limiter must be added at high water pressure endpoint.
- The applicable resources for hot water supply: Suitable for hot water source: It is generally used in pressurized water storage type water heater, and is suitable for gas water heater with heat power of 12L or above, and also requires to be adjusted and matched. Refer to the "Calibration Instructions" below for details.
- It should be used above 4℃. If below 4℃, phenomena like deformation, cracking may occur on the product.

Installation instructions

- Prior to installation, make sure sand grains and other foreign matters inside pipe are removed, so as to avoid blockage, refer to Fig. 1.
- Figure 1 ~ 2 shows the installation instructions and installation step for S joint and Wall-mounted base.
- As for steps of installation and connection, refer to Fig.3~6. Because of different product function and configurations, parts marked with △ are only for installation guide, please take the actual parts as the final.

Inspection of installation

- Check and make sure that all the connection joints are tightened and the handle is in full closed position (this is the ex-factory state), as shown in Figure 7.
- Switch on cold and hot water supply and check joint for leaks, as shown in Figure 6. (Because of different product function and configurations, please take the actual parts as the final.)
- Take down the aerator, rain shower or hand shower, then switch on cold and hot water supply to let water out to remove foreign matters. After that, switch off water supply and reinstall the aerator, rain shower or hand shower to the product.

Cleaning suggestion on Jomoo products

- To avoid product damage and complaint or dispute arising from this, this regulation must be followed when using and cleaning the product.
- Only those detergents that clearly indicate applicability to the product can be used. Detergent containing phosphoric acid must only be used in special conditions.
- Alkaline bleach containing hydrochloric acid, acetic acid or chlorine shall not be used, because such bleach will cause serious damage to product surface.
- Cleaning tool or other equipment that has grinding function shall not be used. For instance, steam cleaner shall not be used, because high temperature will damage the product.
- Instruction of detergent manufacturer must be followed strictly.
- Perform regular cleaning to prevent incrustation scale. When cleaning strictly follow detergent dosage and effecting time.
- Effecting time of detergent shall never be longer than stipulated value.
- Detergent shall not be directly sprayed onto product surface, because detergent will enter product gap and cause damage. Firstly spray detergent on soft cloth and then use soft cloth to wipe product surface.
- After cleaning, enough clear water must be used to clean product surface so as to remove detergent on product surface.
- During use, if bubbler is jammed or water flow volume becomes smaller, dismantle bubbler and remove foreign matters.
- After cleaning, install bubbler back to corresponding position of product. Please keep the aerator spanner properly.
- When shower sprays intermittently, there might be foreign matters blocking the nozzles. At this time, please turn the nozzles slightly to make foreign matters gone with water flushing.

Important notice:

- ⊗ Rigid soap, shampoo and bath foam will damage faucet surface. Therefore, faucet surface shall be cleaned by clear water after taking a bath.
- Note: Using of detergent on damaged surface will cause more serious damage on surface.
- ⊗ Parts with surface damage must be replaced; otherwise there will be injury risk. Any damage arising from cleaning not according to stipulation is not within the company's product warranty scope.
- ⊗ Our company consistently abides by the policy of "continuous improvement of product design and performance" and reserves the right to revise product specification. It is subject to change without notice. Graphic expression is limited to installation guide. Please be subject to actual product.

△ Calibration Description:

- Before installation, inform the customers about the daily use of water heaters, confirm the temperature stability of water heater water outlet, and install after no abnormality.
- After installation, you must check the effluent temperature of the product. If there is deviation between the temperature measured from the outlet of the product and the temperature set on the product, the temperature must be adjusted.
- After the installation of the matched gas water heater is completed, the temperature of the water heater is set at 55℃, 60℃ and 65℃ respectively to test the water outlet effect. If the product water outlet is abnormal, the best condition shall be debugged and the customers shall be guided to use it.

Problem	Cause	Remedy
After installation, the product does not provide water or the amount of water is small	- Hot and cold water is installed on the opposite direction - No water flows in from one end of the pipelines - Water pressure is not within the scope of application	- Check whether the hot and cold inlet sides is hot on the left side and cold on the right side - Check the water situation of the pipeline - Test the inlet pressure of the hot and cold water
After using normally for a period of time, the water do not come out and the amount of water is small	- Thermostatic spool valve and one-way valve clog	- Clean the thermostatic spool valve and one-way valve, and change for new ones if necessary
The water temperature can not be adjusted	- The thermostatic spool valve scales internally - The thermostatic spool valve is blocked by impurities	- Clean the thermostatic spool valve and change for new ones if necessary
The effluent temperature does not match the presetting temperature	- The thermostatic spool valve is not adjusted - The inlet temperature of hot water is too low	- Adjust the thermostatic spool valve - The hot water temperature is raised to 55℃ to 65℃
Under the situation of disorder of hot and cold water or the shutdown of the product, cold water is forced to flow into the hot water side, or vice versa	- One-way valve is blocked or leaky	- Clean the one-way valve and change for a new one if necessary
When using the matched gas water heater, the outlet water temperature can not rise.	- Higher water pressure, larger water outflow and insufficient power of water heater	- Add the shower head water outlet limiter - Lower the set temperature of the water heater
When using the matched gas water heater, no ignition or unstable water temperature	- The water pressure is lower, the water flow is smaller, and the water heater is extinguished at high temperature.	- Remove the shower head water outlet limiter - Raise the set temperature of the water heater



JOMOO KITCHEN & BATH CO., LTD.

Email: jomoo@jomoogroup.com

Http://www.jomoogroup.com