

说明:

安装前请仔细阅读本说明书。
说明书中包含安装、维护和保养信息。
请将说明书交于最终用户
说明书中的部件形状仅供参考, 请以实物为准。

用户需自备的工具:

剪刀 笔(画线用) 切割机(切割安装台面)
电钻 卷尺 直尺 活动扳手 螺纹密封带

用户需自购的部件:

*图形仅供参考, 形状以实物为准。

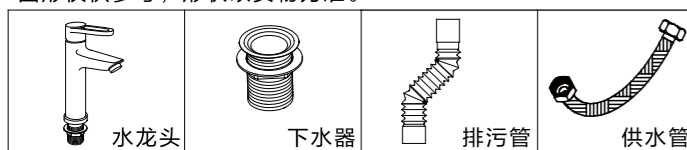

I>艺术盆的安装

1、排污孔位置确定

根据测量艺术盆所得到的排污孔尺寸, 用切割机在安装台面上割出比排污孔足够大的空间, (以便安装下水器, 形状自行确定) 并修整孔的边角。

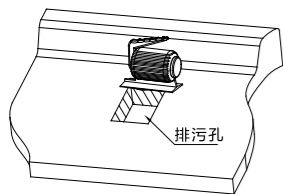

2、水龙头位置确定

根据水龙头和安装台面尺寸正确钻出水龙头安装位置。(若艺术盆上有水龙头安装孔, 则不需要在台面上钻孔)

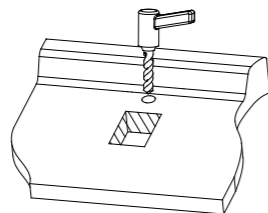

3、艺术盆固定

- 把盆放在安装台面上, 并调整好盆与台面、水龙头安装孔位置。
- 在盆底部周围均匀涂上防霉硅胶。

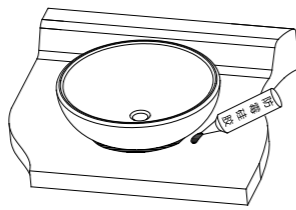
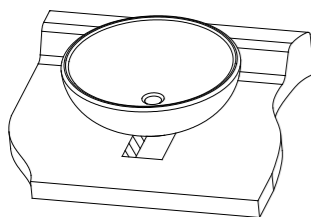

II>台盆的安装

1、台盆安装位置确认

- 将台盆倒放在安装台面上, 用笔沿台面盆边缘画一条轮廓线(如下图虚线), 取下台盆, 根据台盆尺寸画一条台盆安装孔标示线(如下图实线), 注意: 台盆在台面上位置应考虑水龙头供水管尺寸, 同时若台盆不含水龙头安装孔, 需要在台面上预留水龙头安装位置。
- 用切割机沿安装台面上描绘的安装孔标示线割出台盆安装孔, 并修整孔的边角。
- 根据水龙头和安装台面尺寸正确钻出水龙头安装位置。

*此项说明适用于不含龙头安装孔的台盆。

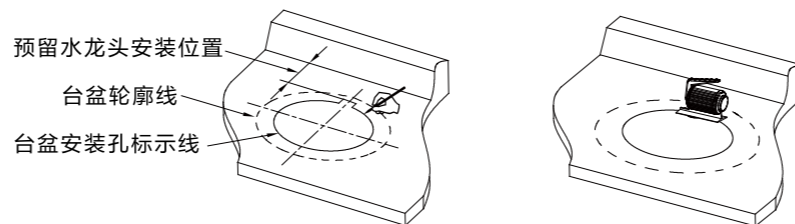

2、台上盆安装

- 在台面上安装孔边缘, 均匀涂上一层防霉硅胶。
- 将台面放置在涂好防霉硅胶的安装台面上安装孔内, 对齐压紧后, 在周围涂上防霉硅胶。
*备注: 不配柜子的半嵌盆安装方式参照台上盆安装。注意台面前端需留出半嵌盆放置位置。

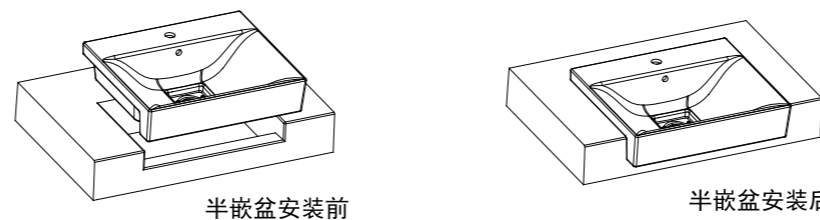

3、台下盆安装

- 在台下盆盆口的凹槽内涂上适量防霉硅胶。
- 若您使用的是石制安装平板, 只需将台下盆对正, 并紧贴安装台面, 直到贴紧。
- 台下盆挂钩安装建议: 将开好台盆孔的台面背部朝上, 然后把台下盆放到台面上, 调整好台盆的位置。将挂片放置到适合位置, 用记号笔标注钻孔位置。最后安装台盆前先在台盆与台面结合处打玻璃密封胶, 然后再拧紧悬挂螺丝。放置12小时以上, 等玻璃密封胶干固后即可进行之后的安装施工。钻孔塞入锥形螺母, 可在周边缝隙内加入少量玻璃密封胶, 干固后可提高承载力。(注意玻璃密封胶不要溢到螺丝孔内)

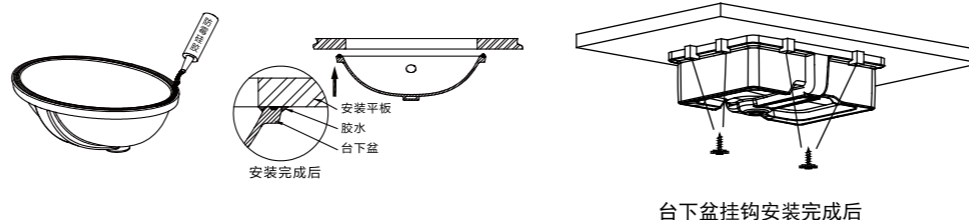

III>柜盆的安装

根据所购柜子的安装说明书, 将柜子进行安装, 再检查所购盆底部轮廓是否能和柜子吻合, 再将盆放在柜子台面上, 并检查盆是否有完全靠墙。

*备注: 适配柜子的半嵌盆安装方式参照柜盆安装。

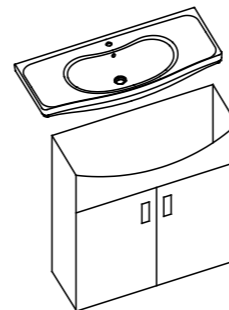

IV>下水器的安装

根据下水器配套的安装说明书, 将下水器安装在柜盆的排污孔上, 再将排污管的一端连接在下水器上。

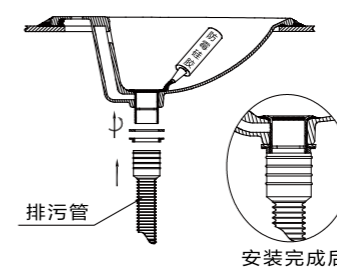

V>水龙头的安装

根据所购水龙头的安装说明书, 把水龙头安装在台面上或艺术盆上, 并将供水管的另一端连接在供水开关上。

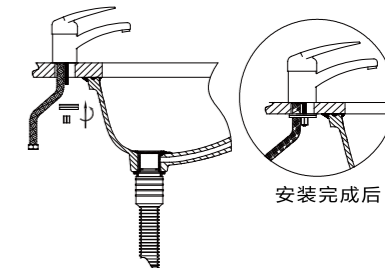

VI>挡水板的安装

首先标出台盆安装轮廓与EVA泡棉安装轮廓, 然后将EVA泡棉按标好的轮廓线安装, 安装步骤如下(安装前需将台面清理干净): 将防水EVA泡棉粘结面的封条撕掉, 把EVA泡棉胶粘于轮廓处, 再将台盆按标好的安装轮廓线安装好(见台盆安装步骤), 保证陶瓷面与EVA泡棉胶紧贴, 为了加强密封性在陶瓷与EVA泡棉胶相接处打上防霉玻璃胶, 最后将多出陶瓷体的EVA泡棉胶截断。(EVA泡棉胶若多次粘接, 导致粘性不足, 可在粘接面上打上防霉玻璃胶, 再进行粘接, 步骤同上述进行。)

*此安装说明仅针对于有配置防水EVA泡棉的盆。

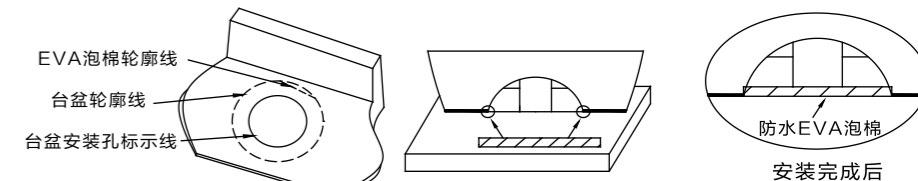

用户须知

- 建议每周用软布将盆擦洗一次, 避免污物沉积。
- 在使用过程中应避免盆与硬物撞击。
- 在清洗盆时, 应用中性质清洁剂清洗, 再用软布擦拭干净。
- 不能使用烈性或腐蚀性清洁剂和尼龙刷或者百洁布之类的用品清洗, 否则会损害盆的表面。
- 涂抹防霉硅胶后, 需将多余的用干布清理掉, 以防影响美观, 并放置24小时以上使其硬化。

警告

- 请选用符合国家标准要求清洁剂, 否则可能会损害釉层或者引起渗漏。
- 本产品禁止使用任何水泥安装, 对所有因水泥安装所引起的产品破裂本公司恕不负责。
- 资料均以印刷时所有最新产品情况为基础, 本公司保留权利随时更改产品特征、包装或者供应情况, 恕不另行通知。
- 请勿使用钢丝球等硬质材料擦洗产品表面, 特别是产品商标处。
- 不要在0°C以下环境使用。

JOMOO

九牧厨卫股份有限公司

地址: 中国福建省南安市经济开发区九牧工业园 邮编: 362308
全国管家服务热线: 400-1919-999 传真: +86 595 86142998
网址: Http://www.jomoo.com.cn 邮箱: jomoo@jomoo.com.cn

Basin Installation Instructions

Note:

Please read the instructions thoroughly before installing.
The instructions contain installation and maintenance information.
This manual should be preserved by end-user.
The picture in the manual is only for reference, please make the object as the standard.

Tools needed by user:

Scissors Pencil(for drawing the line) Adjustable wrench Tape measure
Cutting machine(for cutting lavatory counter top) Ruler Drill motor
Threaded sealing tape

User needs to buy below parts:

*Graphics are only for reference, Please according to the real object.

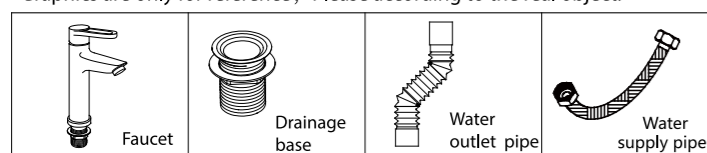

I>Installation of art basin

1. Check the position of waste drainage hole
Check the dimensions of art basin drainage hole, machine cut a enough drainage hole to install waste outlet base, then trim the angles.

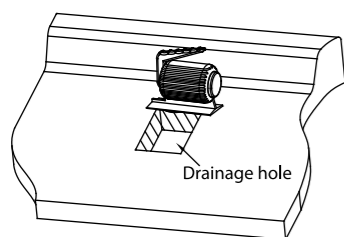

2. Check the position of faucet

Motor drill the specifications of faucet and counter top. (Note: If on the art basin has faucet mounting holes, need not to drill the on the counter top.)

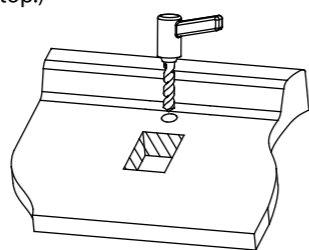

3. Fixation of art basin

①. Place the basin onto lavatory counter top, adjust the positions between the basin and the counter top and the faucet mounting hole.
②. Glue evenly around the basin body with moldproof silica glue.

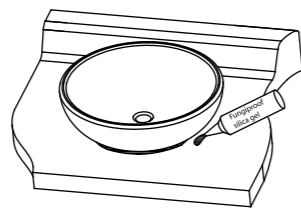
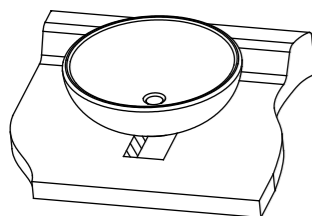

II>Installation of the counter basin

1. Check the under basin installation position

①. Turn the basin upside down on a mounting table board, then draw a contour line along the basin edge (dotted line as shown); remove the basin, draw a marking line of the mounting holes according to the size of the basin. (solid line as shown); (please be noted: the specifications of faucet pipe should be referred to while installing. if the basin without faucet installation hole, reserve faucet installation position on the table.)
②. Machine cut the lavatory counter and drill mounting holes according the marked line, then trim the angles.
③. Motor drill a mounting hole for the faucet installation according to the dimensions.
*This description only applies to basin without faucet hole.

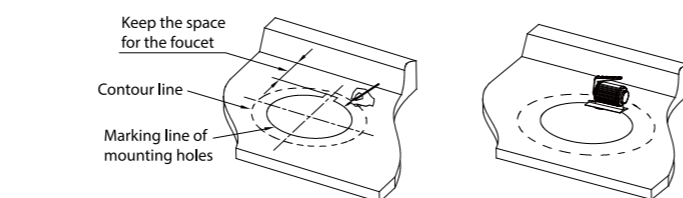

2. Installation of above counter basin

①. Glue evenly around the mounting rims with moldproof silica glue.
②. Put the basin above the mounting holes, which are already moldproof silica glue, align and press it tightly, glue evenly around the mounting rims with moldproof silica glue.
* Note: Semi-basin installation without cabinet refers the basin installation on console. Semi-inlay position should be reserve at the front end of the stage.

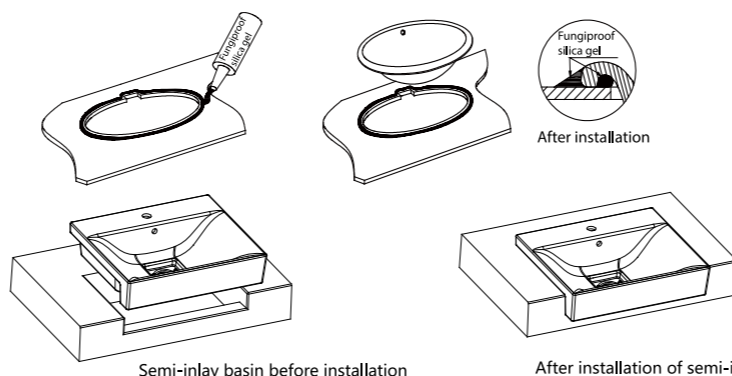

3. Installation of the under counter basin

①. Glue the grooves of the edge.
②. For marble lavatory counter top, please mounting the under basin and attach it tightly.
③. Suggestion for installation of peg hook: Put the back of the table with hole open, then put the under counter basin on the table for the good position of the basin. Then put the hanging piece in a suitable position and marked the position at the drilling hole. The glass sealant should be punched at the joint of the table basin and the table surface before installation of the table basin, then tighten the suspension screw. Place it more than 12 hours, and install it after it is dried and solidified. conical nuts was stuffed into drilling hole, and add small amount of glass sealant into the surrounding cracks, The bearing capacity can be improved after drying and solidifying. (Note that the glass sealant should not spill into the screw hole)

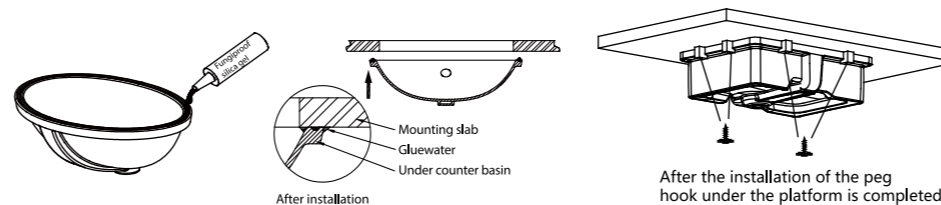

III>Install the cabinet basin

Install the cabinet according to cabinet installation instructions, and check if the shape of basin bottom fits the cabinet, then put the basin onto the cabinet and make sure the basin is fitting the wall.
* Note: The semi-inlay installation mode of the adapted cabinet refers to the installation of the cabinet basin.

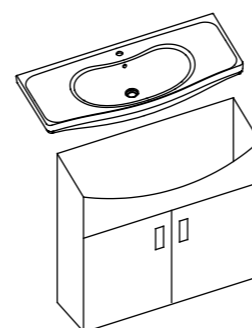

IV>Installation of drainage base

Installed the sewer on the drainage hole of the basin according to the installation, and part of the sewage pipe is connected to the sewer.

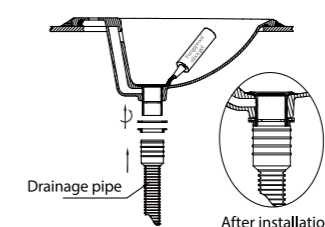

V>Installation of faucet

Installed the faucet on the basin according to the installations and then connected the pipe into the inlet switch.

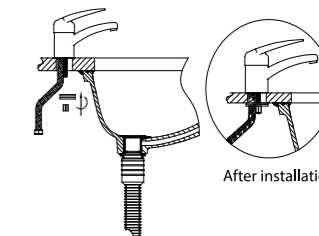

VI>The installation of water retaining plate

Firstly, mark the profile of installation (Basin & EVA foam), then install the EVA foam with its profile (clean it before installation). Rip off the bonding surface seal of EVA water-proof foam, and put the EVA foam type on the hollow place of ceramic basin (as shown in the figure) and make it compact. Put the mould-proof glass cement at the joint of basin and foam type for a better sealing effect, and then rip off the rest of the type. (If type failed to stick after using frequently, please put the glass cement at the joint and repeat steps as mention above.)
The installation is only for the ceramic basin with EVA water-proof foam.

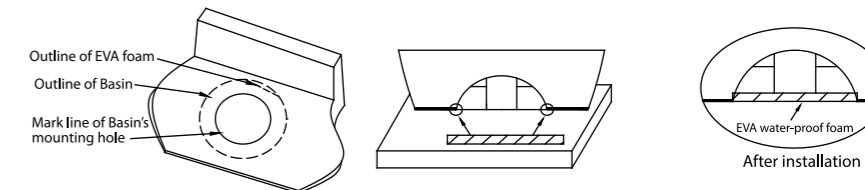

Tips for user:

- It's recommended that user wash the basin with soft cloth once a week to avoid dirt cluster.
- Avoid hard article impacts while using.
- User neutral detergents while cleaning, then wipe the basin with clean cloth.
- Do not use corrosive strong detergent and something like nylon brush while cleaning the surface.
- After applying moldproof silica glue, it is necessary to clean up the excess glue in order not to let glue hard to affect the surface and put it for more than 24 hours.

Warning

- Cleaning detergent should comply with national regulations, otherwise will damage the china surface and cause leaks.
- Cement installing is forbidden for this toilet, Jomoo Group will not hold responsible for any fractures or damages caused by such installation.
- Fittings inside toilet tanks have been assembled properly before ex-factory, please do not change these settings, Jomoo Group will not hold responsible for bad results due to such.
- Please do not use hard materials (like scouring pad) to clean product surface, especially the product logo.
- Do not use the product below 0°C.

JOMOO

JOMOO KITCHEN & BATH CO.,LTD.

Add: JOMOO Industrial Park, Nan'an City, Fujian Province, China.
Tel: 400-1919-999 Fax: +86 595 86142998 P.C: 362308
http://www.jomoo.com.cn E-mail: jomoo@jomoo.com.cn